

PRINCIPAL PARTICULARS

LENGTH O.A.	50.00 M
LENGTH B.P.	41.958 M
BREADTH MLD.	9.30 M
DEPTH MLD.	4.125 M
DESIGN DRAFT	1.90 M
COMPLEMENT	10 CREW 200 OFFSHORE WORKERS
MAIN ENGINE	CAT 3512 C
Rolling/Speed	6600/3500 BHP x 1800 rpm
Gearbox	TWIN DISC/ZF 7600 A

Lampiran 3 : General Arrangement CB. Pan Marine 18 / 19

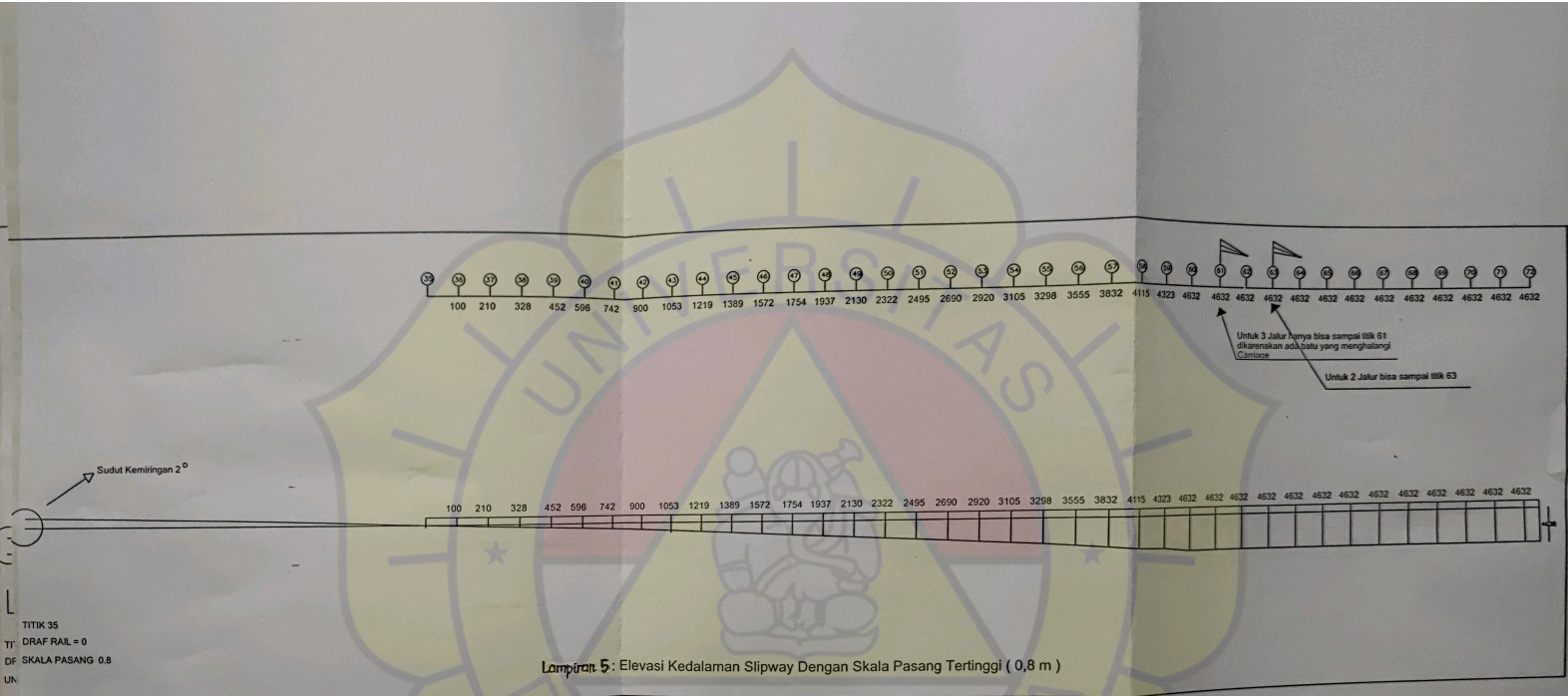

Lampiran 5: Elevasi Kedalaman Slipway Dengan Skala Pasang Tertinggi (0,8 m)

Sudut Kemiringan 2°

TITIK 42
DRAFT RAIL = 0
UNTUK SKALA AIR LAUT SURUT

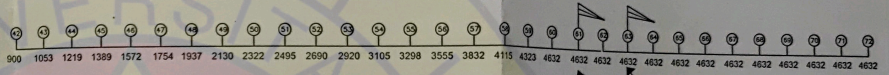

Untuk 3 Jalur hanya bisa sampai titik 61 dikarenakan ada batu yang menghalangi Cantone

Untuk 2 Jalur bisa sampai titik 63

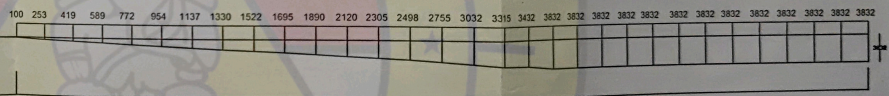

Lampiran 6 Elevasi Kedalaman Slipway Pada Saat Air Laut Surut

CARRIAGE TYPE 1
(REQUIRED : 4 Unit)

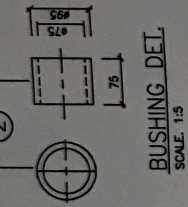
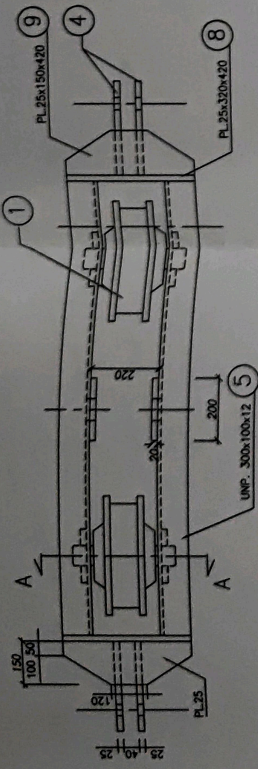

BUSHING DET.
SCALE: 1:5

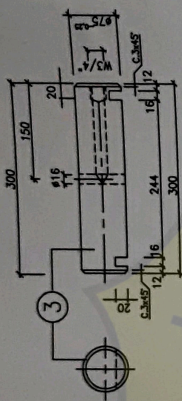

AXLE DET.
SCALE: 1:5

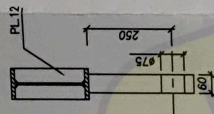

SECTION. D~D
SCALE: 1:5

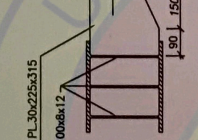

SECTION. C~C
SCALE: 1:5

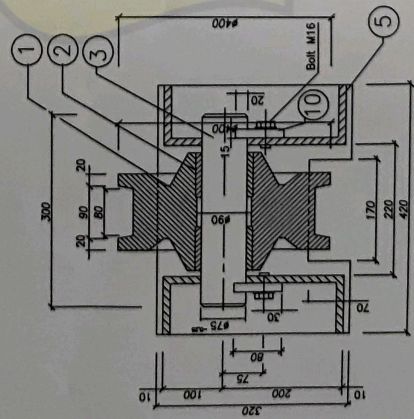
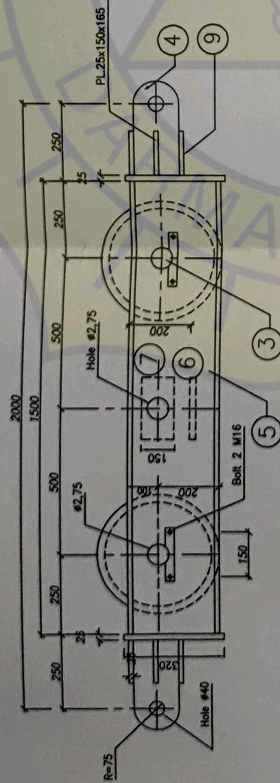

SECTION. A ~ A
SCALE: 1:5

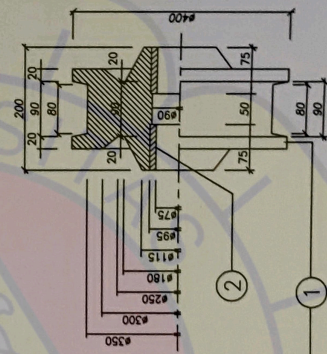

WHEEL DET.
SCALE: 1:5

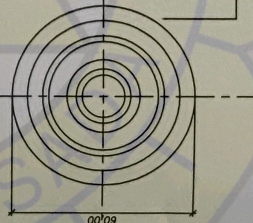

NO:	QTY	NAME	MATERIAL
15	1	Bracket	SS. 41 PL
14	1	Axle	S 45 C
13	1	Bushing	Bronze
12	1	Wheel	Cast Steel
11	4	PL 25x150x420	SS. 41 PL
10	4	PL 15x80x200	SS. 41 PL
9	4	PL 25x150x420	SS. 41 PL
8	2	PL 25x320x420	SS. 41 PL
7	2	PL 25x420x700	SS. 41 PL
6	1	PL 25x220x500	SS. 41 PL
5	2	Carriage	L300.100
4	4	Bracket	SS. 41 PL
3	2	Axle	S 45 C
2	4	Bushing	Bronze
1	2	Wheel	Cast Steel

SLIP WAY

HAL. 116

PROJECT

DATE

APPROVED BY:

DATE

DRAWN: Tardja.S

FILE: CAR-001

REV.

Lampiran 14 : Konstruksi Roda Carriage Galangan " X "

SCALE: 1:10, 1:5

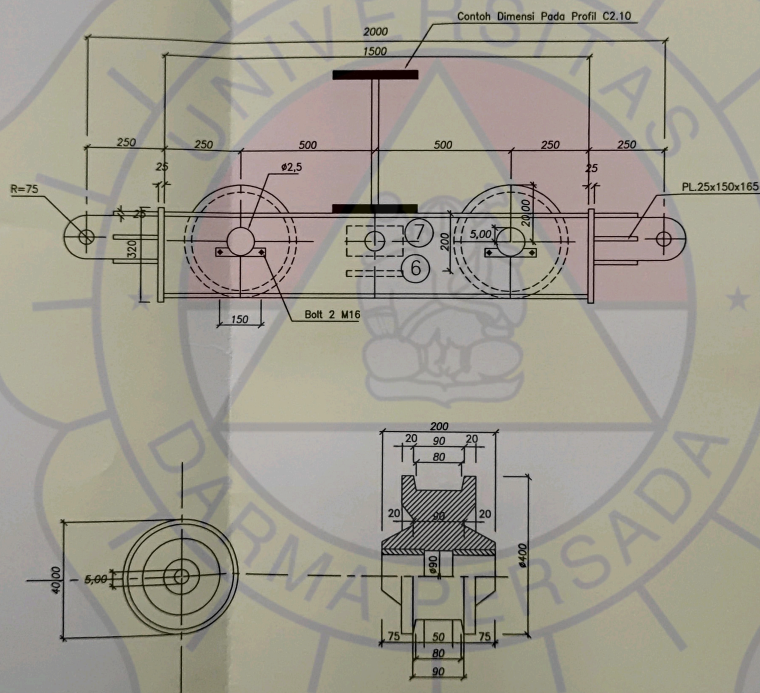
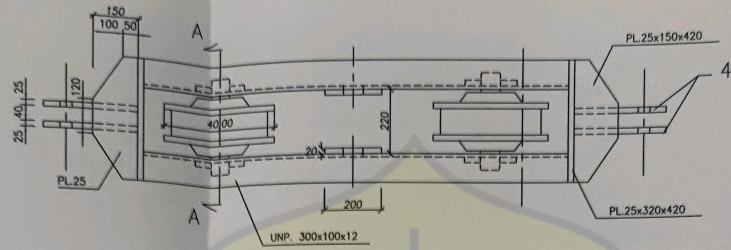

TITIK APUNG NO. 52
DENGAN KEDALAMAN : 2690
UNTUK DRAFT RIG 1,3 Meter + FP KAPAL 1.3 Meter : 2600 M
PADA SKALA PASANG 0.8+

Sudut Kemiringan 2°

TITIK 35
DRAF RAIL = 0
SKALA PASANG 0.8

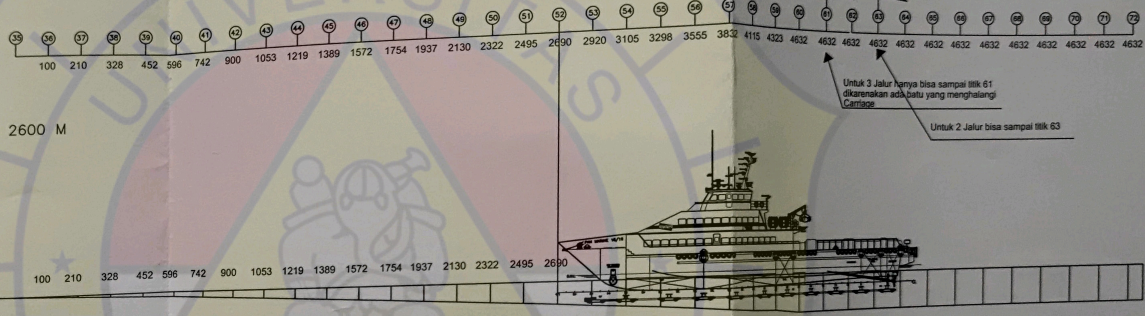

Untuk 3 Jalur Agnya bisa sampai titik 61
dikarenakan ada batu yang menghalangi
Gangway

Untuk 2 Jalur bisa sampai titik 63

Lampiran 22 : Diagram Apung CB. Pan Marine 18/19